

Phase 3 of I-40 construction at Manuelito Canyon begins March 30

Written by Staff Reports
Friday, 03 April 2020 07:15

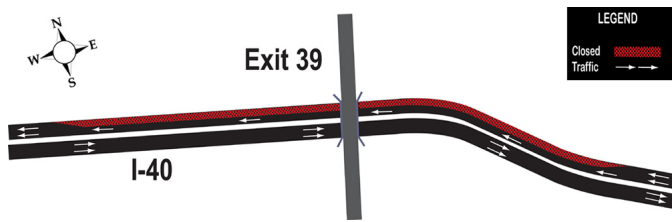

Road construction is set to start March 30 on Phase 3 of a multi-phase project to rebuild .33 miles of I-40 about four miles east of the Arizona/New Mexico state line.

The \$14 million project includes roadway reconstruction on I-40 eastbound and westbound, bridge reconstruction, new signing and striping of the roadway, grading of the channel under the bridge, and installation of rip rap to control erosion in the channel. Construction is expected to be completed in late 2020.

During Phase 3 of construction:

One lane of I-40 eastbound traffic will be shifted to the new westbound I-40 bridge, so crews can demolish the existing eastbound bridge and start construction on the new bridge.

Westbound I-40 traffic will be on the outside westbound I-40 lane.

Phase 3 of I-40 construction at Manuelito Canyon begins March 30

Written by Staff Reports
Friday, 03 April 2020 07:15

Crews will also continue construction of the channel.

Regular work hours will be Monday through Friday 7 am - 5 pm, although crews may work longer hours or on weekends as needed. All construction is weather permitting and is subject to change without notice.

Motorists traveling in the project area should expect delays, follow all construction signs, obey reduced speed limits, and give themselves extra time to reach their destination.

I-40 is also under construction at Exit 39 in McKinley County east of Gallup.

For updated traffic information, dial 511 or visit www.nmroads.com